

THIRD ANGLE PROJECTION



NOTES:-

1. MAXIMUM BOARD SIZE 180mm X 140mm.
2. ALL COMPONENTS TO BE GLUED AND TIE WRAPPED TO BOARD.
3. BOARD TRACKS TO BE DESIGNED FOR MAXIMUM CURRENT HANDLING CAPABILITY (70u/SOFT COPPER TRACK).
4. BOARD TO BE FIREPROOF/FIBREGLASS.
5. RESISTOR TO BE FITTED TO A HEATSINK WITH RIVETS.
6. WIRE - STRANDED 2.0mm CSA.
7. PLUGS FITTED TO WIRES IS AMP REF. 1-480424-0

PCB	FR4 1.6mm THICK 70u			
C1	POLYPROPYLENE	±10%	250V DC	25uF
C2	POLYPROPYLENE	±10%	250V DC	6.8uF
L1	AIR CORE 1.5mm MIN DIA. WIRE	±5%	DCR 0.3 ohm	1.75mH
L2	AIR CORE 1.0mm MIN DIA. WIRE	±5%	DCR 0.5 ohm	0.22mH
R1	ALUMINIUM HOUSED RESISTOR (HS50)		50W	8.2ohm

PART No.		7300 1290
First used on		CMS1201
Issues		
1	24/02/10	GW
2	21/11/11	GW

GREEN AND THE YELLOW WIRES REVERSED TO SUIT POLARITY CHANGE.
CR 8843

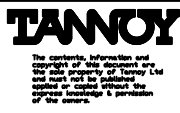
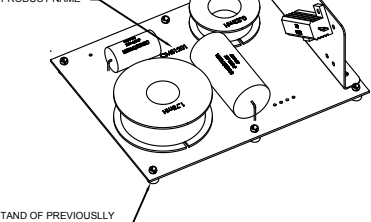
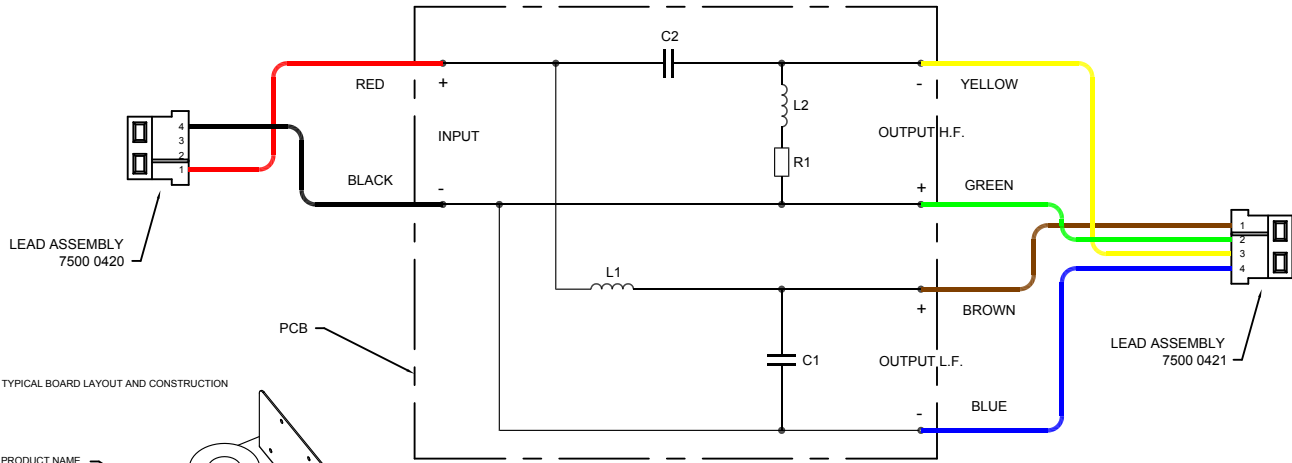

MATERIAL	FINISH	ALL DIMENSIONS IN MILLIMETERS	RoHS Compliant
		Limits of tolerance unless stated	Drawn
		One place of decimal dia.	Checked
		Two places of decimal dia.	Approved
		Holes 12.0mm dia & under	Scale
		Holes over 12.0mm dia.	
TITLE	CROSSOVER TYPE 1683 - CMS1201	CROSSOVER TYPE 1683 - CMS1201	7300 1290

A2