

No scale

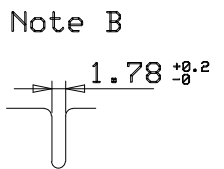

All dimensions are in millimeters

All Vias with diameter 0.4 shall be plugged

Tolerances (unless otherwise stated)  $\pm 0.2$

DESIGN LPC	DRAWN ANMAG	CHECKED	DICO4B03	REPLACES 090717	REPLACED BY
				DATE 100331	PAGE
				DRAWING NO	DICO4B03